

Cement Resistor - SQV Series

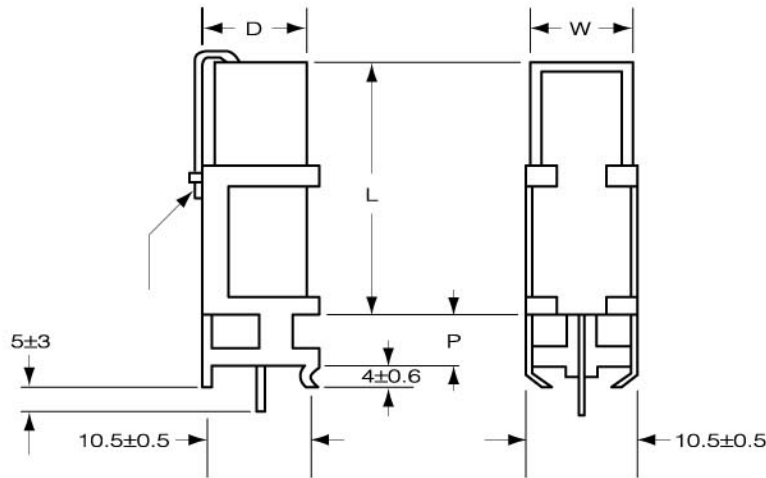

DIMENSIONS (mm):

STYLE	DIMENSIONS (mm)				RESISTANCE	
	W	D	L	P	Wirewound	RS
5W	10.0±2.0	9.0±1.0	22.0±1.0	5.0±2.0	0.1Ω ~ 200Ω	200Ω ~ 50Ω
7W	10.0±2.0	9.0±1.0	35.0±1.0	10.0±2.0	0.1Ω ~ 300Ω	300Ω ~ 50Ω
10W	10.0±2.0	9.0±1.0	48.0±1.0	10.0±2.0	0.1Ω ~ 500Ω	500Ω ~ 50Ω
15W	12.5±2.0	12.5±1.0	49.0±1.0	10.0±2.0	0.1Ω ~ 680Ω	680 ~ 50K
20W	13.0±2.0	13.0±1.0	60.0±1.0	10.0±2.0	0.1Ω ~ 820Ω	820 ~ 50K

ELECTRICAL CHARACTERISTICS:

Style	Power Rating 70°C	SQV-5W	SQV-7W	SQV-10W
	Operating Temp. Range		-55°C ~ +155°C	
Max. Working Voltage		350V	500V	500V
Max. Overload Voltage		700V	1000V	1000V
Dielectric Withstanding Voltage (AC)		700V	1000V	1000V
Temp. Coefficient		±300ppm/°C		

- * a. Standard resistance is as the above list, below or over this resistance is on request.
- b. Value for NKN Non-Inductive type is up to 50Ω only.

DERATING CURVE

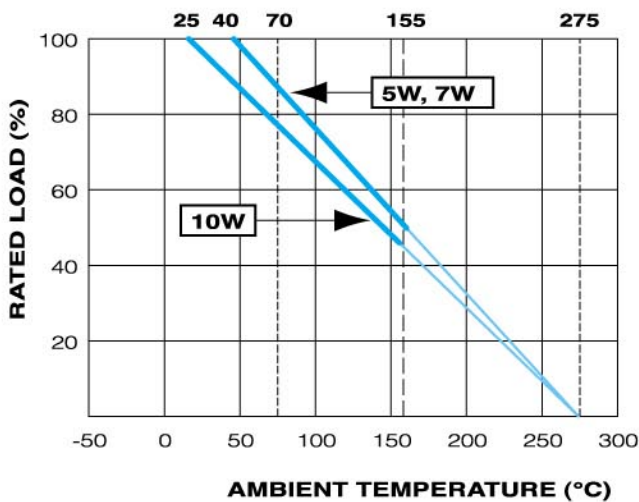

TEMPERATURE RISE

