



# METALIZED POLYESTER CAPACITOR

## -MET Series

---

**MET** are constructed with metalized polyester film dielectric, copperplated lead, outer wrapped by polyester film tape and ends sealed by epoxy resin in non-inductive type. They are suitable for coupling, by-pass filtering timing circuit decoupling and use in data processing, auto control system, telecommunication, industrial instruments.



### FEATURES:

- Non-inductive construction.
- Good solderability.
- Self-healing property.
- High stability of capacitance and of reliability.

### SPECIFICATION:

1. OPERATING TEMPERATURE :  $-40^{\circ}\text{C} \sim +85^{\circ}\text{C}$
2. CAPACITANCE RANGE :  $.01 \sim 10\mu\text{F}$
3. CAPACITANCE TOLERANCE : J( $\pm 5\%$ ), K( $\pm 10\%$ ), M( $\pm 20\%$ )
4. RATED VOLTAGE : 100VDC, 250VDC, 400VDC, 630VDC
5. DISSIPATION FACTOR : 1.0% MAX
6. INSULATION RESISTANCE :
  - >  $15000\text{M}\Omega$  ( $C \leq .33\mu\text{F}$ )
  - >  $5000\text{M}\Omega$  ( $C > .33\mu\text{F}$ )

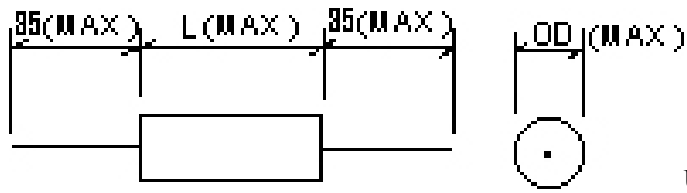

Unit:mm

CAP	RV	100VDC			250VDC			400VDC			630VDC		
	SIZE	L	OD	d	L	OD	d	L	OD	d	L	OD	d
.01								15	6	0.6	15	6	0.6
.015								15	6	0.6	15	7	0.6
.022								15	6	0.6	15	8	0.6
.033								15	6.5	0.6	15	8	0.6
.047					15	6	0.6	15	7	0.6	22	8	0.6
.068					15	6	0.6	15	9.5	0.6	22	9	0.6
.1		15	6	0.6	15	6	0.6	22	9	0.6	27	10	0.6
.15		15	6	0.6	15	7	0.6	22	9	0.6	27	11	0.8
.22		15	6.5	0.6	22	7	0.6	27	9	0.8	27	13	0.8
.33		22	7	0.6	22	7.5	0.6	27	10	0.8	32	14	0.8
.47		22	7.5	0.6	22	8.5	0.8	27	12	0.8	32	15	0.8
.68		22	8.5	0.6	22	9	0.8	32	12.5	0.8	32	18	0.8
.1		22	10	0.8	27	11	0.8	32	15	0.8	32	20.5	0.8
1.5		27	10.5	0.8	27	12	0.8	32	18	0.8			
2.2		27	11	0.8	32	13.5	0.8						
3.3		27	14	0.8	32	16.5	0.8						
4.7		32	15	0.8									
6.8		32	17.5	0.8									
10		32	20.5	0.8									